

We respectfully request an accommodation to the required enclosed private parking spaces based on exception (v). Since we moved to Cleveland Heights over a decade ago, our family has thankfully grown and as the kids grow up our living quarters have become tight. The additional bedrooms and living area will enable our family to live in our home comfortably. We would like to attach a one car garage to our house. This will allow greenspace for our children to play in, which will be greatly reduced should we need to maintain the current 20x20 structure. In addition, it will enable more practical use of the garage especially in inclement weather.

PN 23-22

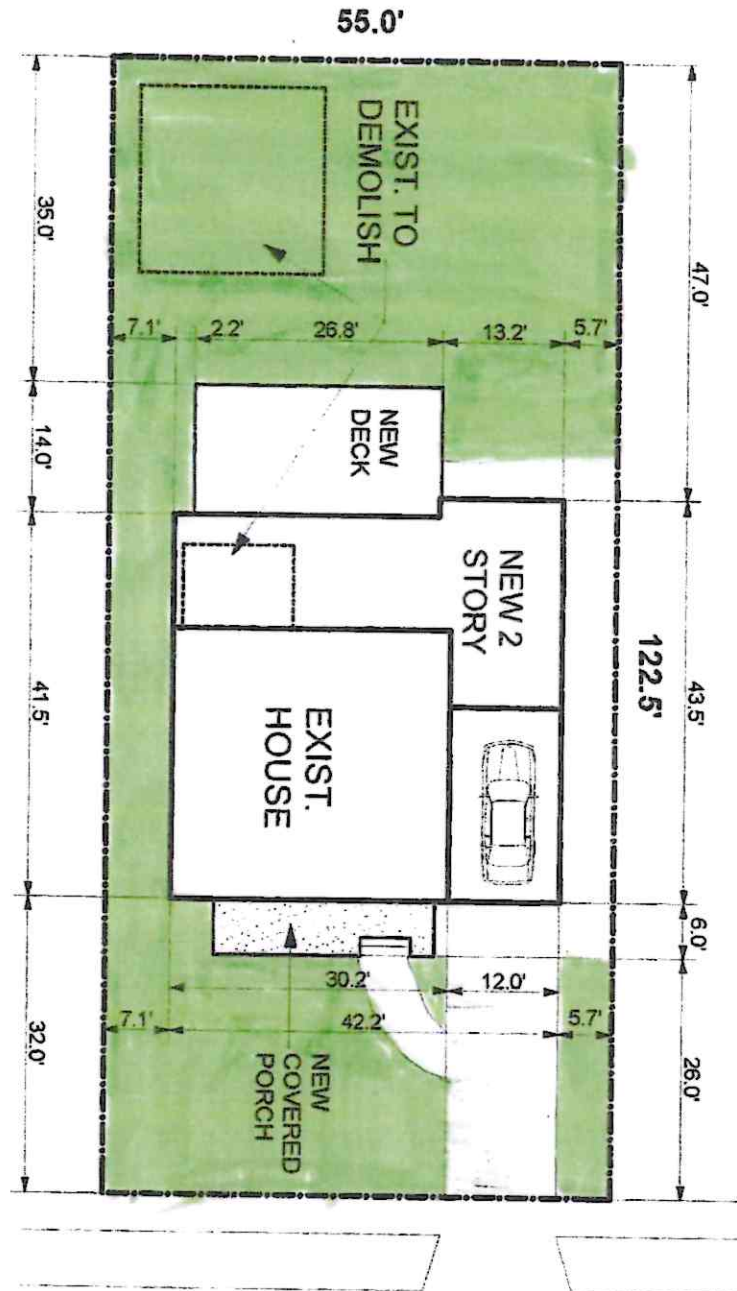

Site and landscape plan



SHANNON Rd.